

Single Hole Bidet

(481) Drop Cross Handle

7.0048195

## FEATURES:

- All brass construction
- Includes pop-up drain assembly with overflow.
- Swivel aerator
- 12" Stainless steel flex lines are supplied
- Maximum deck thickness: 1-1/2"
- Replacement cartridge: 18.30.035-cold, 18.30.036-hot
- Available in all finishes. Warranty varies according to finish selection.
- Meets: ASME A112.18.1/CSA B125.1-2011

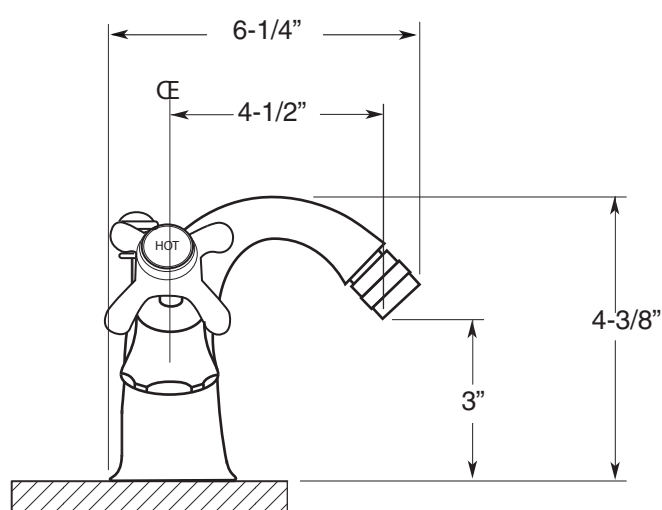

NOTE: Allow 1-1/4" diameter hole for installation

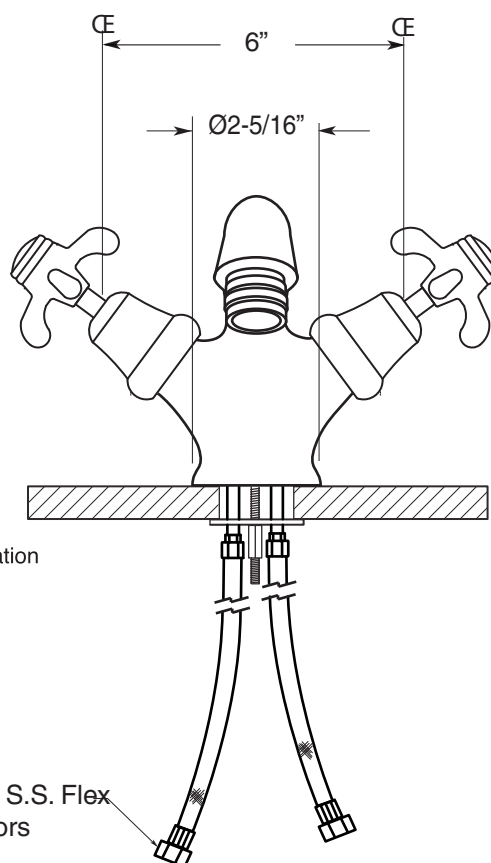

3/8" x 12" S.S. Flex  
Connectors

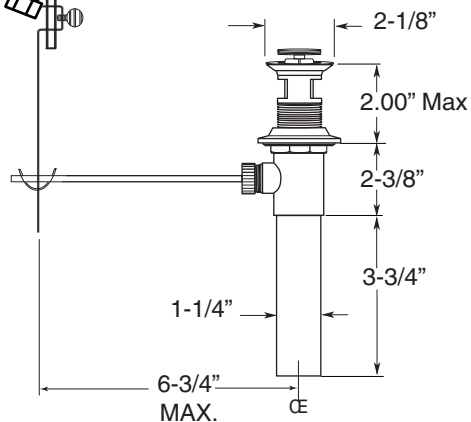

Note: Measurements are subject to change or cancellation. No responsibility is assumed for use of superseded or voided pages.