



# SPECIFICATIONS

## Reserve Collection

Exposed Thermostatic Tub and  
Shower System  
(158) Lever

7.00158870

### FEATURES:

- All brass construction.
  - Solid brass dial assembly preset @ 110 Max.
  - Thermostatic valve cartridge P/N: 18.30.176
  - Porcelain handshower wand P/N: 18.10.205
  - 60" Spiral Hose supplied P/N: 18.10.016
  - Showerhead replacement: 18.10.052EXP
  - Available in all finishes. Warranty varies according to finish selection.
  - Meets: ASME A112.18.1-2005/CSAB125.1-2005
- NOTE: Do not rough without copper rough-in guide.  
Guide is sent ahead by default.

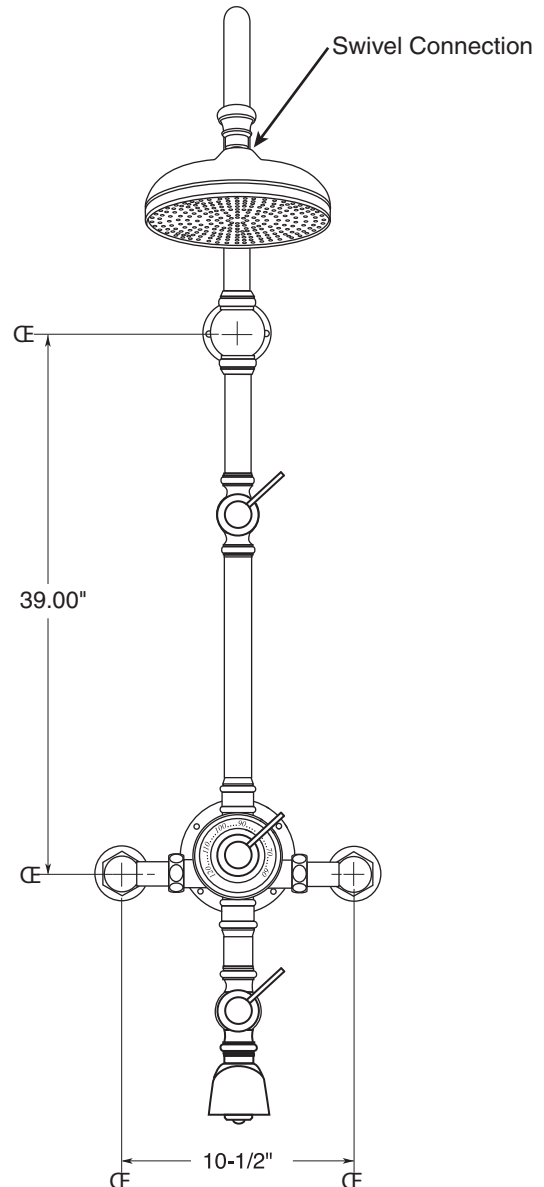
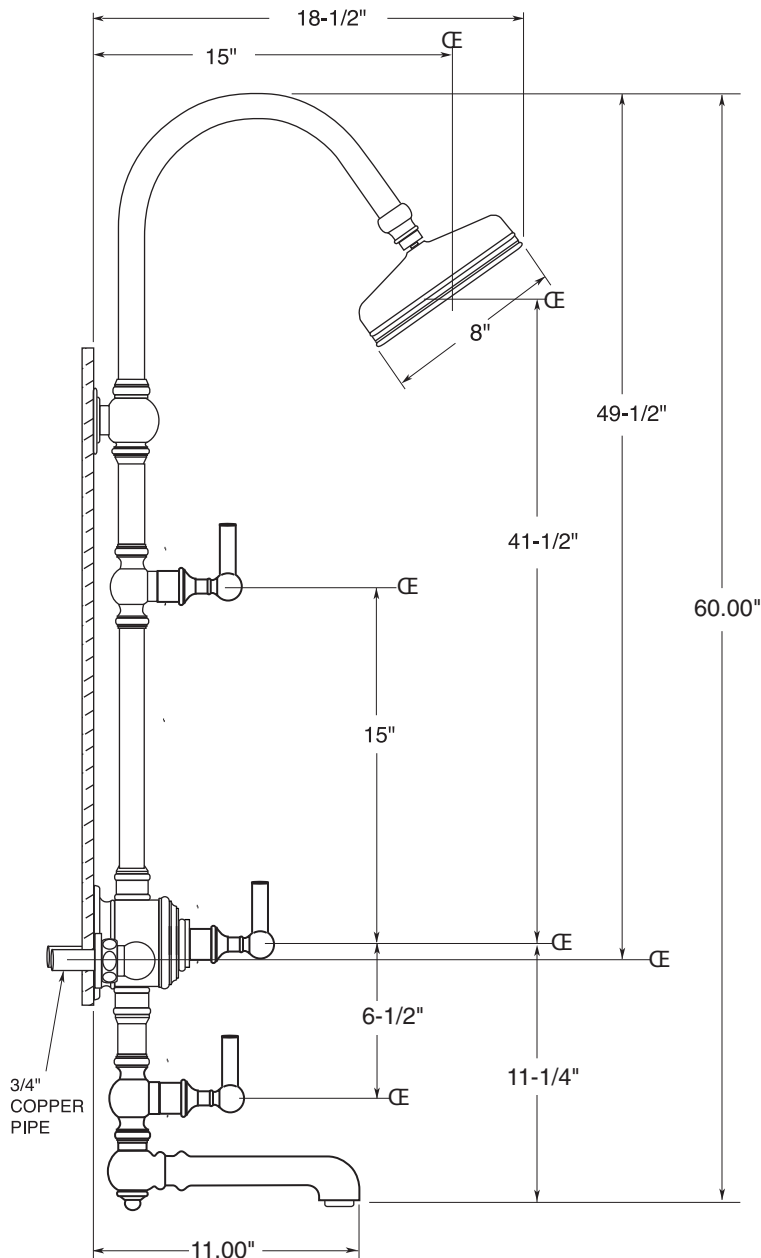

Note: Measurements are subject to change or cancellation. No responsibility is assumed for use of superseded or voided pages.