

FEATURES:

- All brass construction
- Independent corner valves
- Includes grid drain without overflow. P/N 18.11.120
- Standard aerator is limited to 1.5 gpm
- 1/4-turn ceramic disc valve cartridge
- Available in all finishes. Warranty varies according to finish selection.
- Certified to meet and exceed the following codes and standards:
ASME A112.18.1/CSA B125.1-2011

TechData Specifications

Rutherford

Vessel Lavatory Set
(485) Porcelain Lever
7.5548507
(7.5548507T - Trim only)

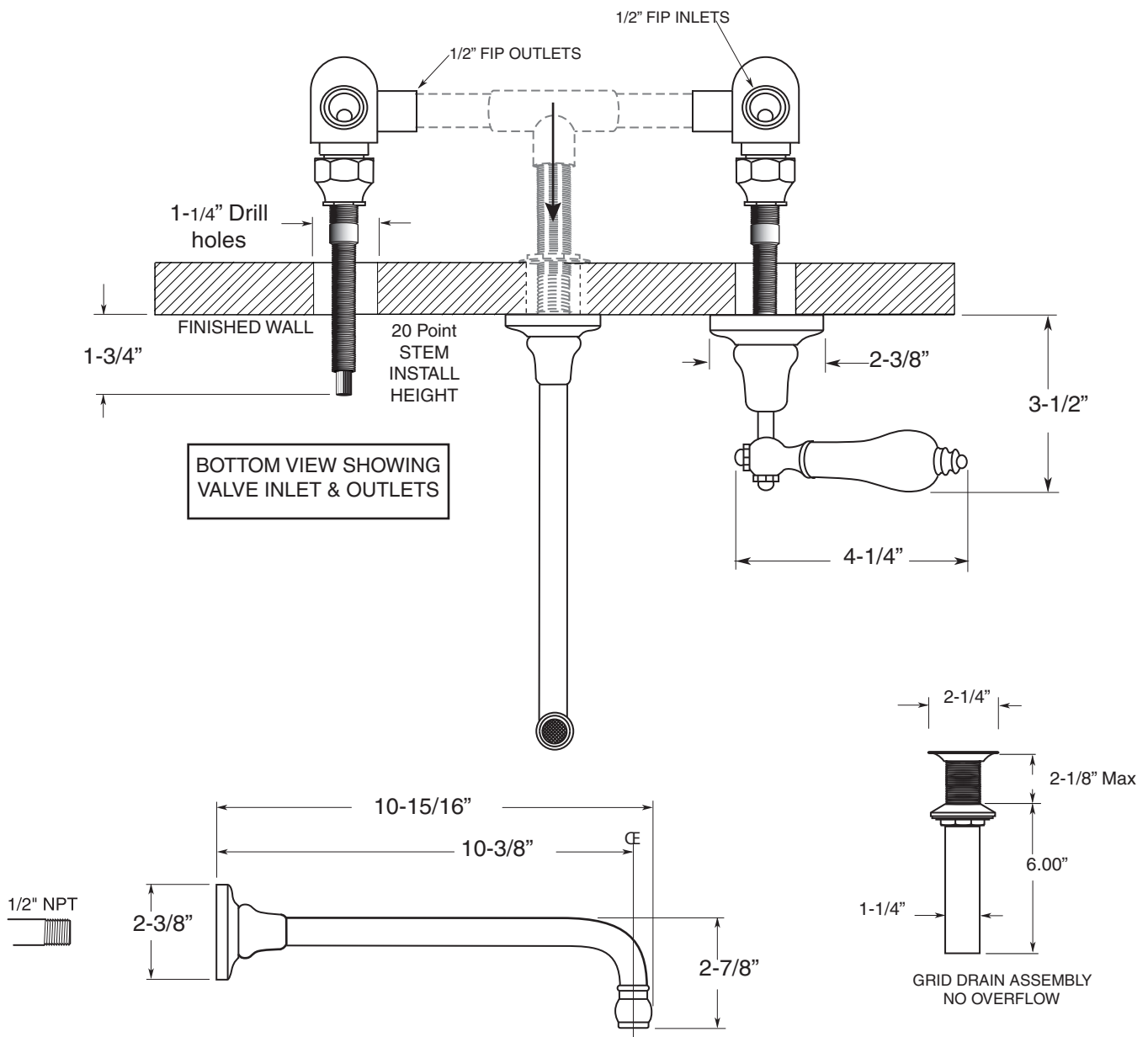

Note: Measurements are subject to change or cancellation. No responsibility is assumed for use of superseded or voided pages.

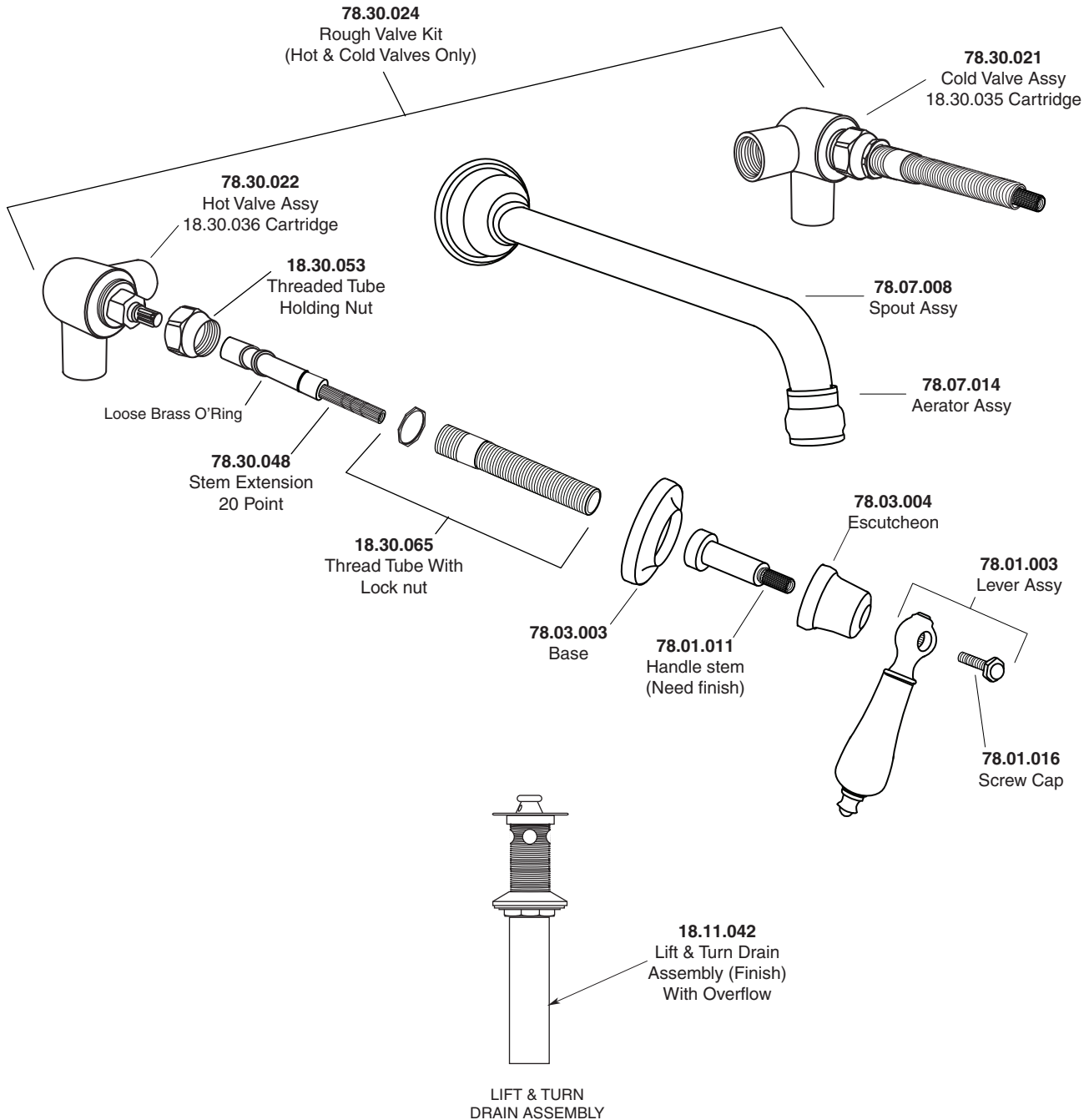

Note: Measurements are subject to change or cancellation. No responsibility is assumed for use of superseded or voided pages.