

FEATURES:

- All brass construction
- Independent corner valves
- Includes lift & turn drain with overflow. P/N 18.11.042
- Standard aerator is limited to 1.5 gpm
- 1/4-turn ceramic disc valve cartridge
- Available only in True Brushed Stainless Steel
- Certified to meet and exceed the following codes and standards:
ASME A112.18.1/CSA B125.1-2011

Vessel Lavatory Set
True Brushed Stainless Steel
7.2109007
(7.2109007T - Trim only)

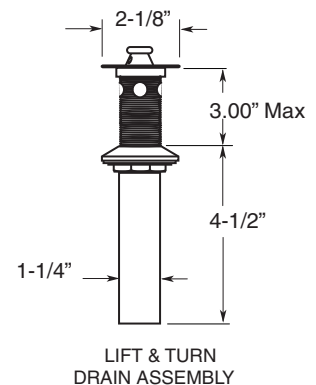
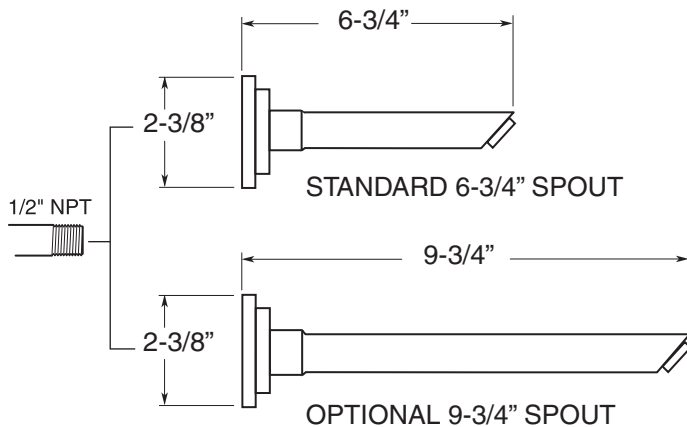
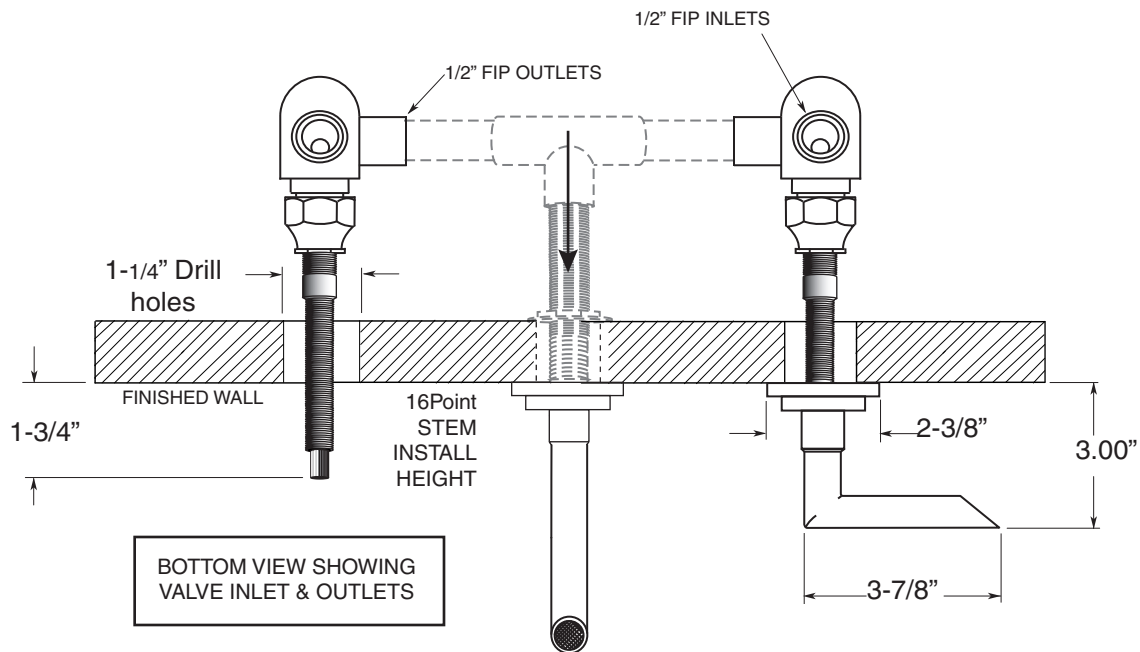

Note: Measurements are subject to change or cancellation. No responsibility is assumed for use of superseded or voided pages.

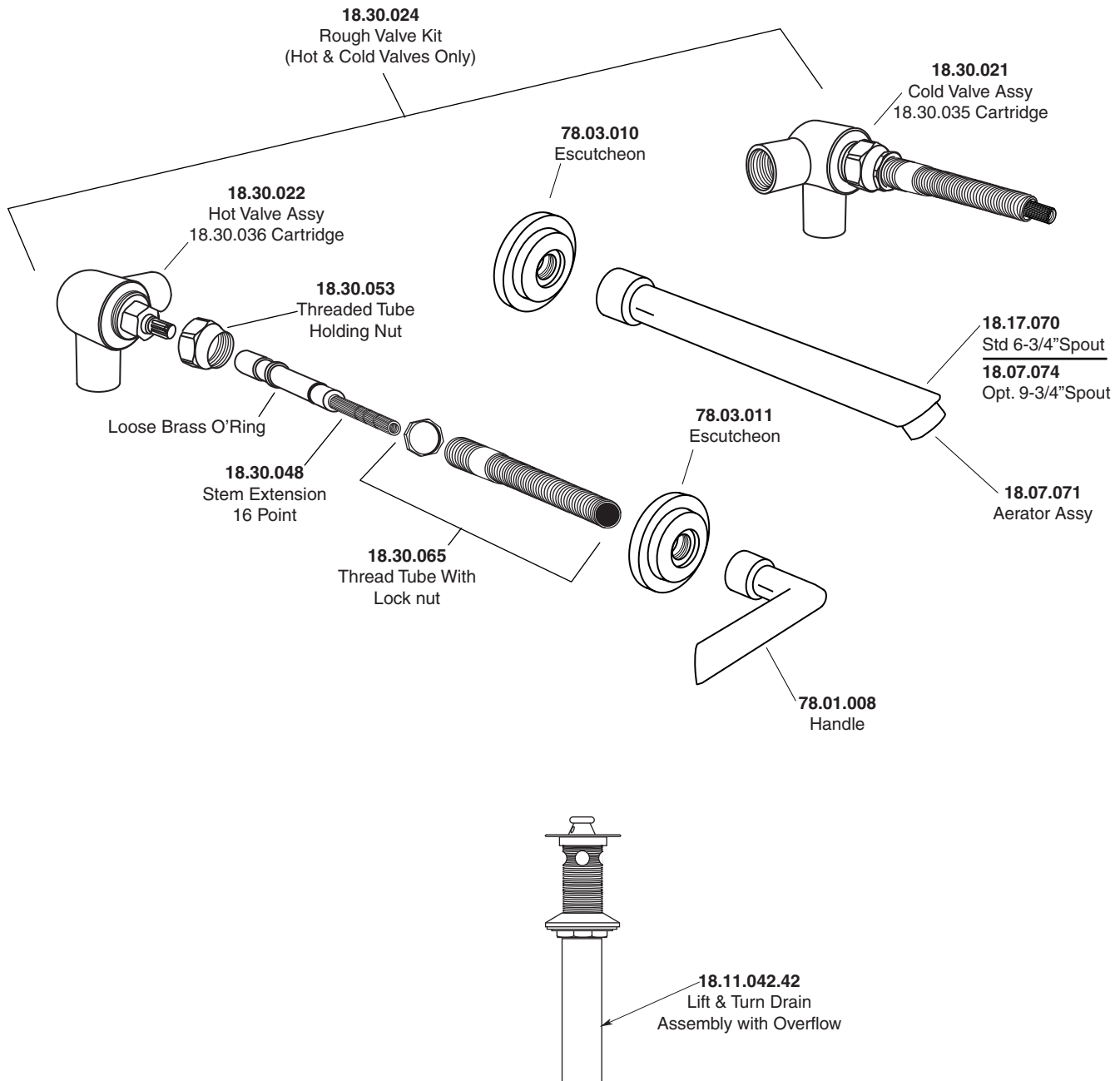

Note: Measurements are subject to change or cancellation. No responsibility is assumed for use of superseded or voided pages.