

FEATURES:

- All brass construction.
- Aerator is limited 2.2 GPM
- Concealed aerator requires special supplied removal key.
- 3/4" x 1/2" offset elbows allow center-to-center flexibility from 5-3/8" min to "7.00" max.
- Replacement cartridge: 18.30.035 - cold, 18.30.036 - hot
- Available in all finishes. Warranty varies according to selection.
- Certified to meet or exceed the following codes and standards:
ASME A112.18.1/CSAB 125.1-2011

TechData

Specification

Sancerre

Wallmount Kitchen
or
Bar Faucet
Swivel Spout
(485) Porcelain Lever

7.57485033

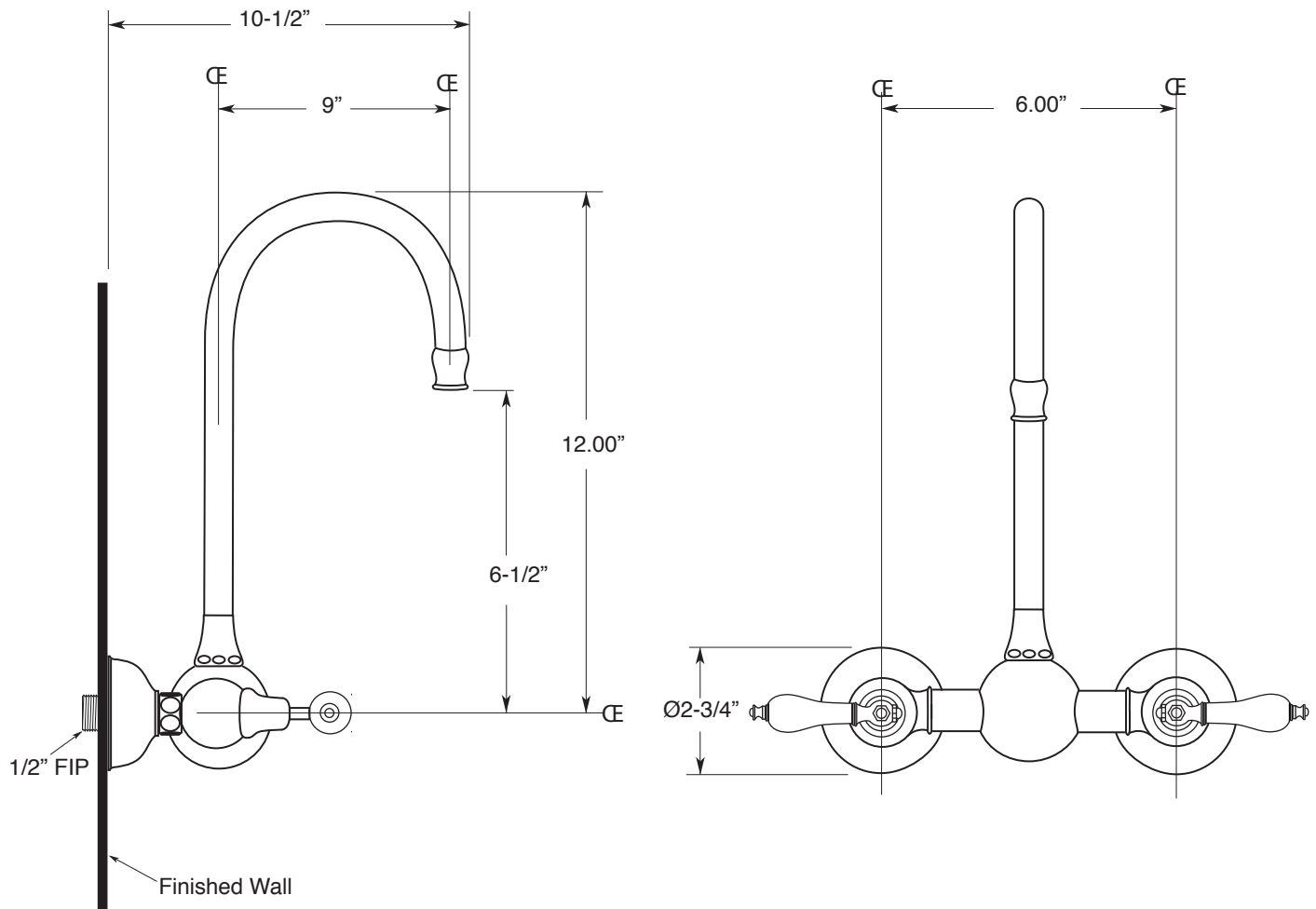

Note: Measurements are subject to change or cancellation. No responsibility is assumed for use of superseded or voided pages.