

E-Mini Thermostatic Trim W/ Round Plate and Nova II Handle

1.0R4851T

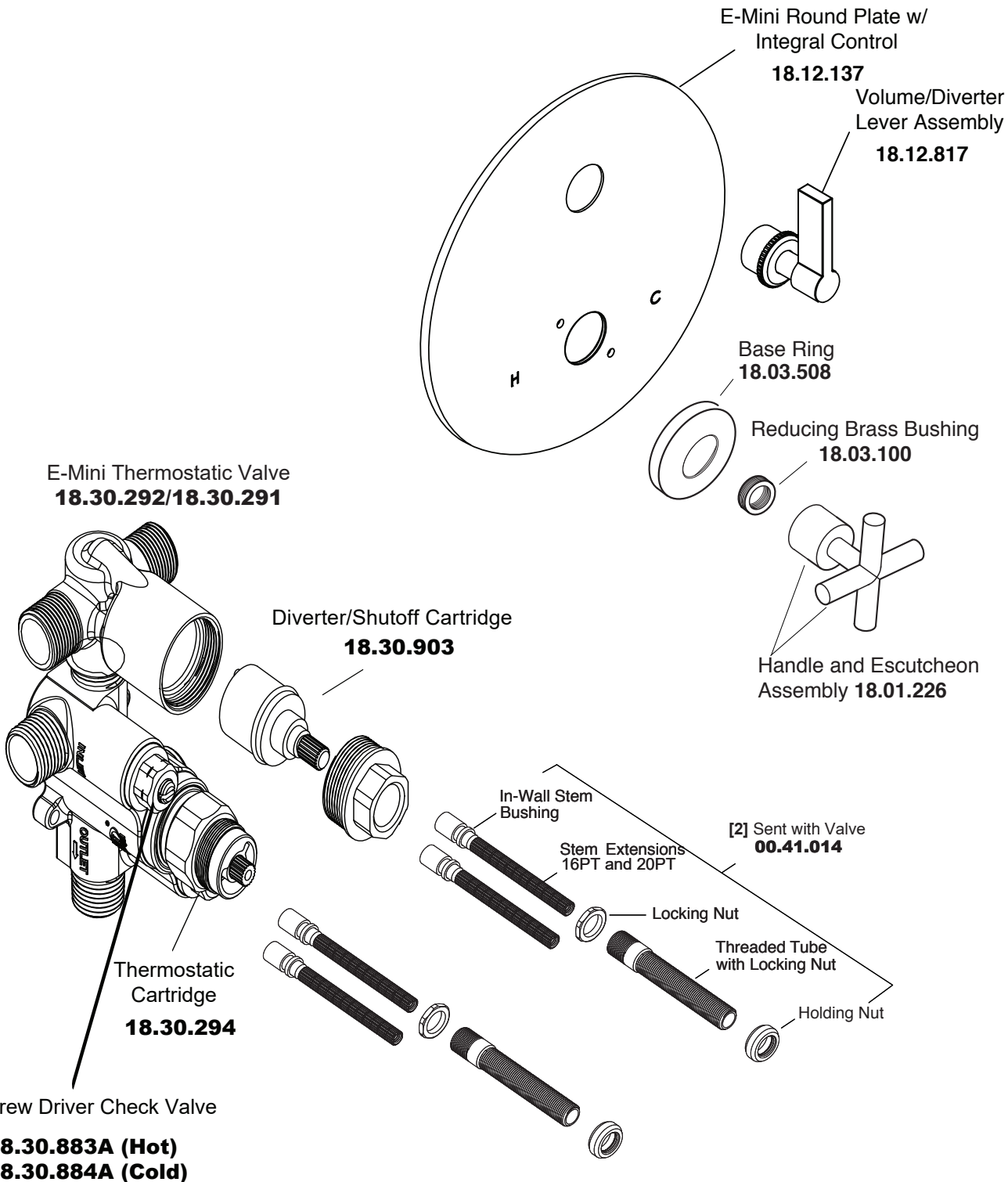

E-Mini Thermostatic Valve
18.30.292/18.30.291

E-Mini Round Plate w/
Integral Control
18.12.137

Volume/Diverter
Lever Assembly
18.12.817

Base Ring
18.03.508

Reducing Brass Bushing
18.03.100

Handle and Escutcheon
Assembly **18.01.226**

Diverter/Shutoff Cartridge
18.30.903

Thermostatic
Cartridge
18.30.294

[2] Sent with Valve
00.41.014

In-Wall Stem
Bushing
Stem Extensions
16PT and 20PT

Locking Nut

Threaded Tube
with Locking Nut

Holding Nut

Screw Driver Check Valve

18.30.883A (Hot)
18.30.884A (Cold)